



Printer registration manual

Real-time Light for CL4-SXR/CL6-SXR

January 26, 2026

Ver. 1.0





Table of Contents

1.	Revision History	3
2.	Check your network environment	4
3.	For adding printers to SATO Online Services	4
3-1.	DNS settings	5
3-2.	Set Proxy settings. (Mandatory if proxy server is used)	5
3-3.	SOS mode settings	6
4.	Prepare to register your printer	7
4-1.	Select SOS connection	7
4-2.	Printer serial number is shown	7
4-3.	PIN code input screen is shown	7
5.	Register your printer via SOS Smart App	8
5-1.	Login to SOS Smart App	8
5-2.	Read via NFC	9
5-3.	Enter printer information	9
5-4.	Restart the printer	10
6.	Register your printer via PC	11
6-1.	Login to SATO Online Services	11
6-2.	Enter printer serial number	11
6-3.	Return to "Printer screen" and enter the PIN code	11
6-4.	Association code is shown	12
6-5.	Go to SATO Online Services screen in PC	12
7.	Confirmation	13
8.	Update the printer's firmware	14



1. **Revision History**

Version	Issued on	Revision history
Ver. 1.0	Jan 26, 2026	First edition



2. Check your network environment

To connect SOS via your network, the following ports are required to be opened
Port No. : 443/TCP and Port No. : 8883/TCP *Both use outbound only

<Connect method 1>

connect via firewall both of Port No.443 and 8883

<Connect method 2>

Port No.443 connect via proxy server. Port No.8883 connect via firewall.

3. For adding printers to SATO Online Services

To connect printers to SATO Online Services, Set the following printer setting it is necessary to change the network settings of your printers.

- | | |
|---------------|--|
| •DNS | required |
| •Proxy server | required if it connect via proxy server. |
| •NTP | optional |

And it is also necessary to prepare following information.

1. SOS account (ID, PW)
2. Definition of unique printer name and it's location name.

If Multiple locations are existing, we recommend registering location settings beforehand.

*** This describes only for SOS setting. For other network settings (IP, Subnet, Gateway and WLAN settings), please refer to the printer manual.**

<https://www.manual.sato-global.com/printer/cl-sxr/en/main/index.html>



3-1. DNS settings

Show setting menu of printer.

Settings => Interface => Network => Wired => IPv4

15:13 SOS NFC

← IPv4

Mode	Static
IP Address	192.168.17.75
Netmask	255.255.252.0
Gateway	192.168.16.1
Primary DNS	192.168.16.1
Secondary DNS	192.168.1.1

✓

<Example>

Mode	Static
IP Address	192.168.17.75
Netmask	255.255.252.0
Gateway	192.196.16.1
DNS	192.168.16.1, 192.168.1.1

*Three DNS address can be set

*DNS is not required if DHCP is set.

3-2. Set Proxy settings. (Mandatory if proxy server is used)

- ① Show proxy setting screen of product's menu

Settings => Interface => Network => Advanced => Proxy

- ② Set proxy server value km(IP address and port number) in the Server.

ex.) http://172.18.1.10:8080 (http://{IP Address}:{Port number})

- ③ Set the Username and Password respectively. **If the username and password are not available in the proxy server, this setting is not required.**

- ④ Check exclude setting contains「127.0.0.1, localhost」.

「127.0.0.1, localhost」 are static value. **Leave this setting and no change.**

And if there is no value set on this menu, please enter 127.0.0.1, localhost manually

- ⑤ Check the checkbox to enable the valid item.

15:21 SOS NFC

← Proxy

Proxy	<input checked="" type="checkbox"/>
Server	http://
Port	0
User Name	
Password	****
Exclude	127.0.0.1, localhost

↺



3-3. **SOS mode settings**

① Show SOS mode settings screen.

1. Settings ⇒ Cloud Services ⇒ SATO Online Services ⇒ Mode ⇒

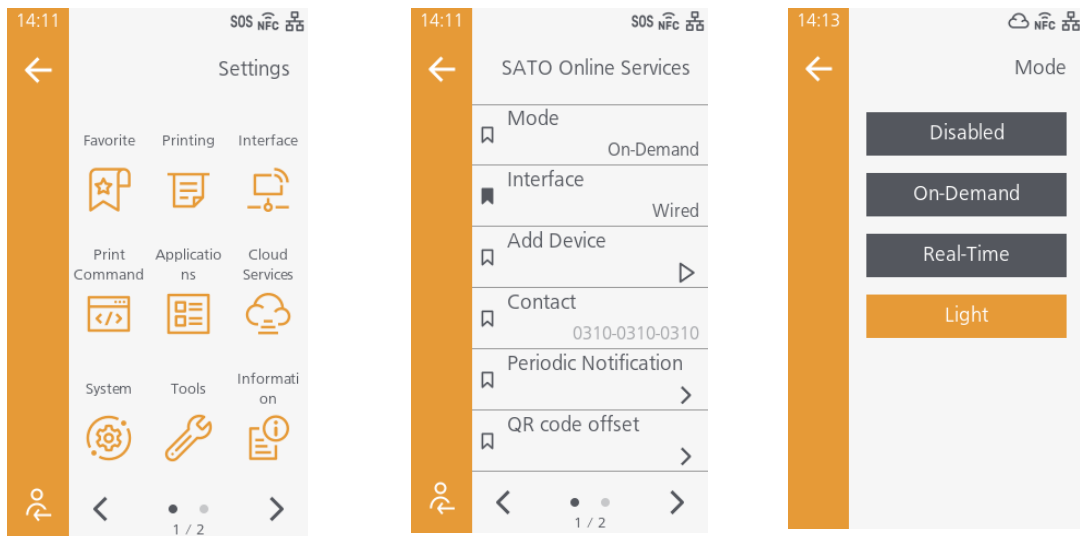

② Set SOS Mode to Light from Disable

③ Check the terms of SOS and agree them.

4. Prepare to register your printer

4-1. Select SOS connection

Settings ⇒ Cloud Services ⇒ SATO Online Services ⇒ Add Device



4-2. Printer serial number is shown

Printer serial number is needed to login to SATO Online Services and register your printer.

4-3. PIN code input screen is shown

When this screen is shown, acquire a PIN code, following the below step.

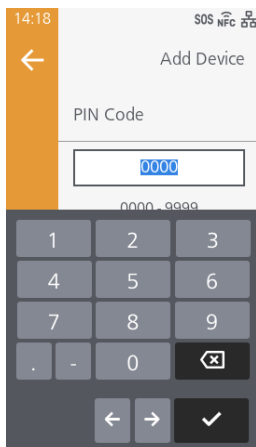

Following two steps can be used. Choose the applicable one depending on registration method.

Register via smartphone=> register your printer via SOS Smart App

Register via PC=> register your printer via PC

5. Register your printer via SOS Smart App

5-1. Login to SOS Smart App

- Login to SOS Smart App and tap [Add printer].
- Tap [Real-time(Light)] in the printer registration screen.

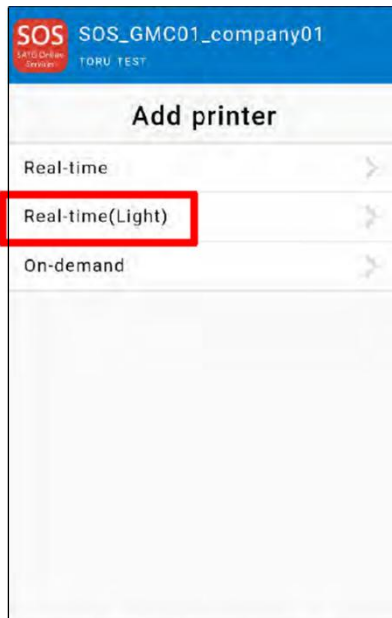
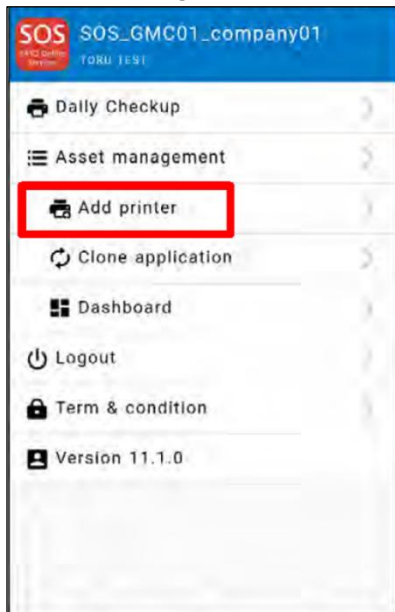



5-2. Read via NFC

While the light mode connection screen is shown, place the smartphone close to the printer NFC area. NFC is mounted in a red circle portion of the below picture.



5-3. Enter printer information

When the screen is read via NFC, below screen is shown. Enter the model name, location using SOS Smart App and tap [Add] button.

SOS SOS_GMC01_company01 TORU TEST	
Real-time(Light)	
1. Serial number	5E001224
2. Device name	5E001224
3. Installation location	America Factory
Add	



5-4. **Restart the printer**

After the printer information is added, long-press the power button of the printer to turn off the power once, then restart the printer.



6. Register your printer via PC.

6-1. Login to SATO Online Services

<https://www.sato-sos.com/> => login to SOS

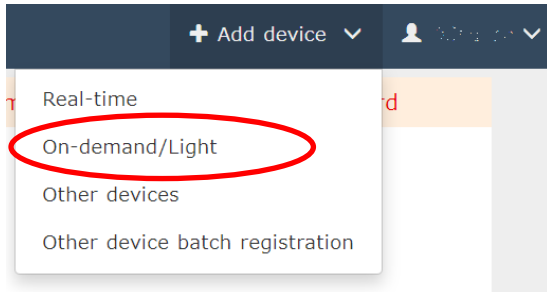

• Login to SATO Online Services with your account and click On-demand/Light mode in the printer registration shown at the top right of the screen.

*You need to register for a SOS account beforehand.

6-2. Enter printer serial number

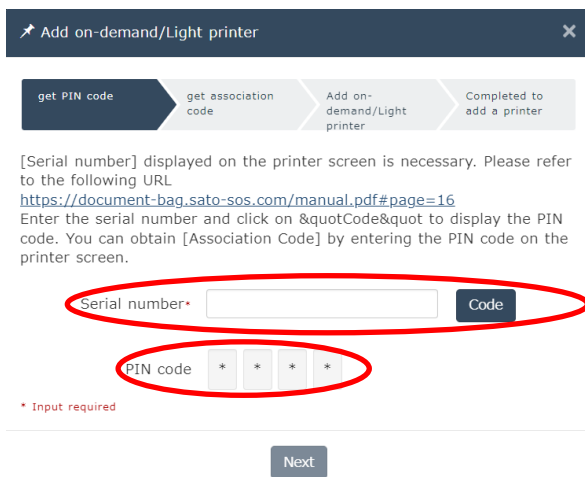

get PIN code → get association code → Add on-demand/Light printer → Completed to add a printer

[Serial number] displayed on the printer screen is necessary. Please refer to the following URL
<https://document-bag.sato-sos.com/manual.pdf#page=16>
 Enter the serial number and click on "Code" to display the PIN code. You can obtain [Association Code] by entering the PIN code on the printer screen.

Serial number* Code

PIN code * * * *

* Input required

Next

• Input screen of the printer serial number is shown. Enter the serial number of the added printer and click [Code] button.

*Enter the printer serial number you made a note in the Step 5-2.

• PIN code is shown.

*This PIN code is necessary to identify the added printer.

*It is recommended to make a note of the PIN code.

6-3. Return to "Printer screen" and enter the PIN code

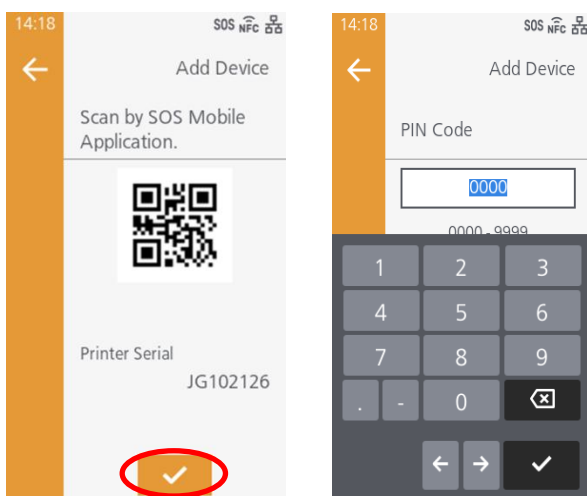

• Enter the given PIN code in the Web screen.

• Press the right softkey [✓] of the printer to confirm the entered PIN code.

*Enter the PIN code you made a note in Step 7-2.

6-4. Association code is shown

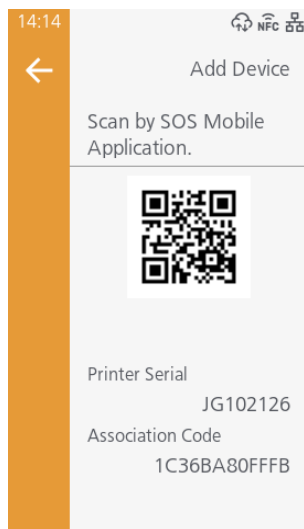

• Printer serial number and association code are shown in the printer screen.

***It is recommended to make a note of the association code.**

6-5. Go to SATO Online Services screen in PC

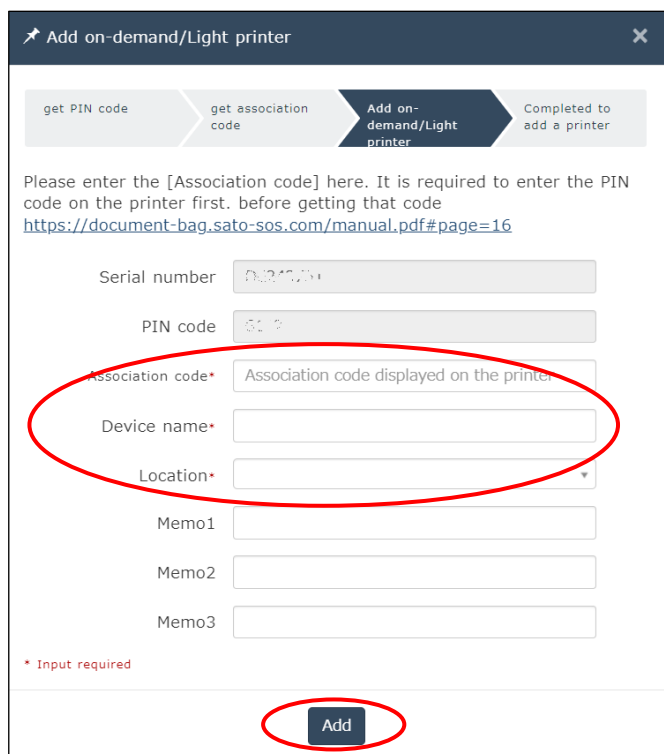

• Click [Next] in the Add QR connection printer screen.

• Association code input screen is shown.

(Left image)

• Enter the association code shown in the printer.

• Enter the printer name.

• Enter the location.

• Click [Add] button.

7. Confirmation.

Check the "Device list" of SATO Online Services show operated serial number.

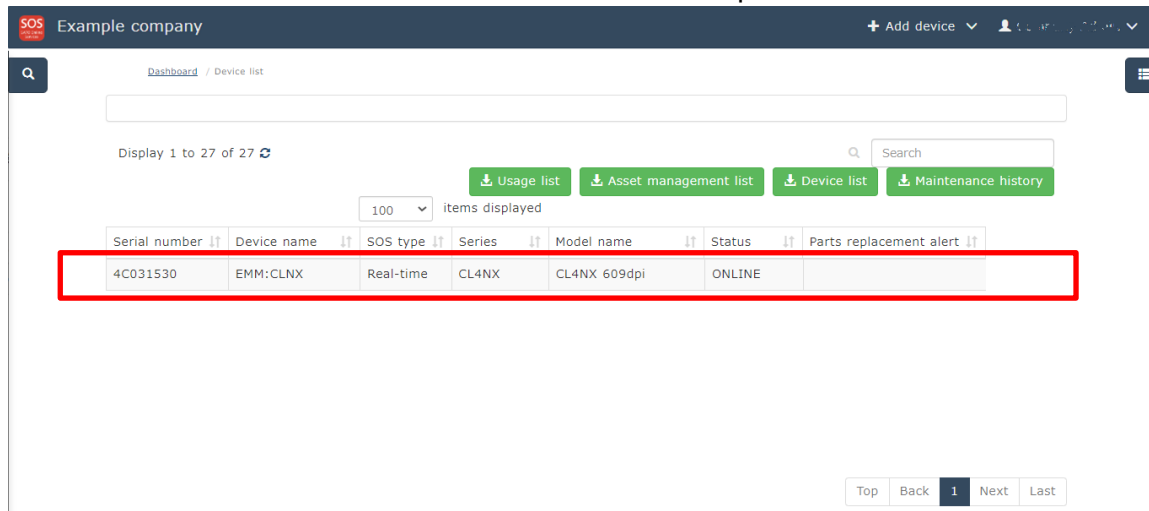

Serial number	Device name	SOS type	Series	Model name	Status	Parts replacement alert
4C031530	EMM:CLNX	Real-time	CL4NX	CL4NX 609dpi	ONLINE	

Registration process is completed.

Please see following manual for check other information.

https://www.sato-sos.com/en/support/sos_usermanual.pdf

* The above registration process can also be performed from SOS Smart App (application for SOS smartphone).

Also, SOS Smart App is convenient to input the association code by QR code reading function.

For details, refer to the SOS Smart App manual.

https://www.sato-sos.com/en/support/sos_usermanual_mobile.pdf

8. Update the printer's firmware

SAS (SATO App Storage) account is required for firmware updates.

Please prepare your "Company ID, Login ID, and Password".

Settings ⇒ Cloud Services ⇒ SATO App Storage ⇒ Authentication ⇒ Firmware Update

